

NOTES	
1	MODEL SHOWN IS 12' VEHICLE CLEARANCE HEIGHT. REFER TO ELP DRAWING FOR DETAILED CONFIGURATION OF SPECIFIC JOB
2	PLUMBING, ELECTRICAL PNEUMATIC AND ROUTING: REFER TO ELP DRAWING OR CUSTOM MANUFACTURING DRAWING OF SPECIFIC JOB ORDER FOR MORE DETAIL.
3	2 GREASE LINES (P/N 964-0000) ARE REQUIRED.

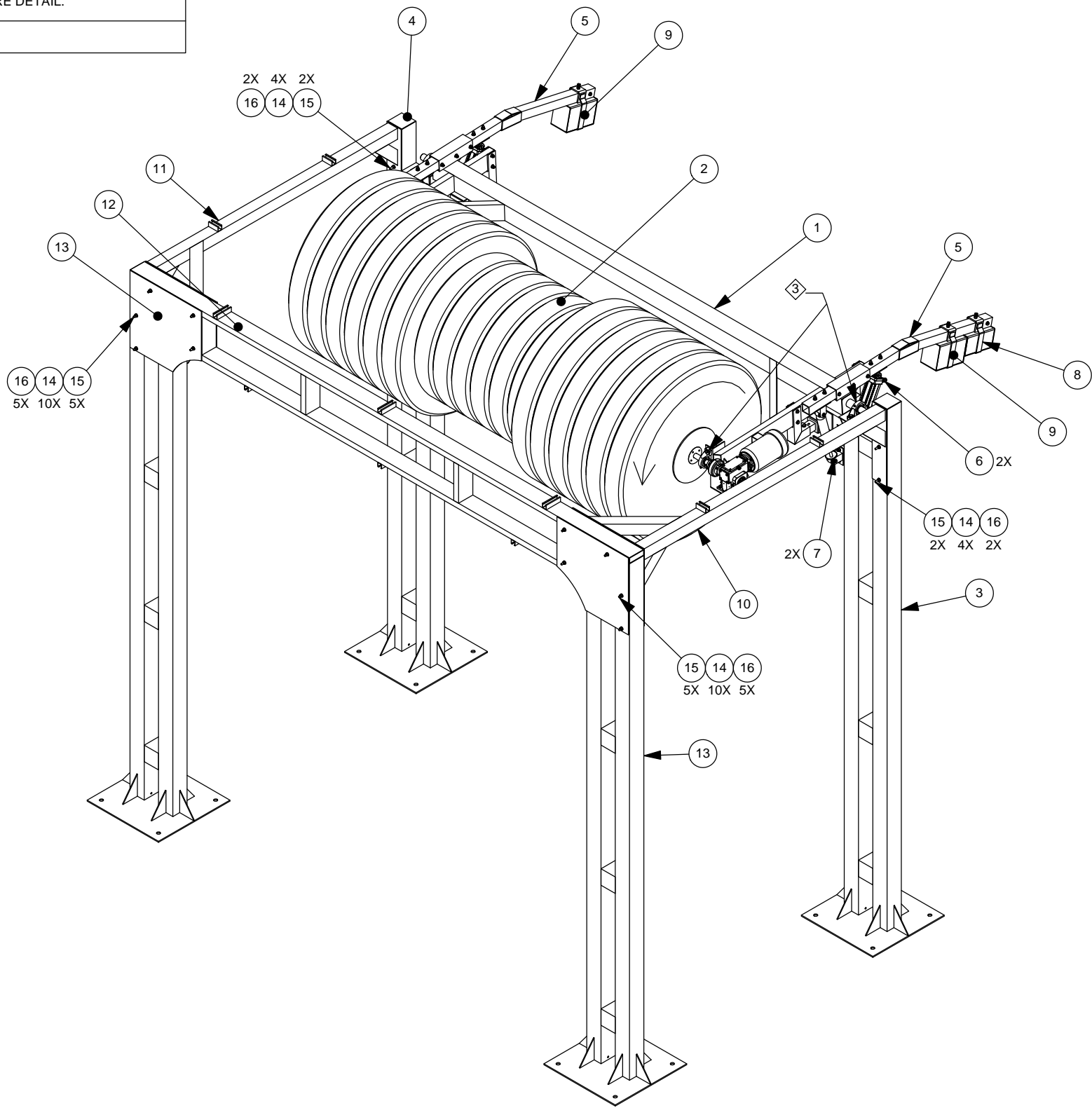

ITEM NO.	PART NUMBER	DESCRIPTION	QTY.
1	960-0034	TRAIN WASH TOP BRUSH YOKE ASSEMBLY, S.S.	1
2	960-0035	TRAIN WASH TOP BRUSH BRUSH ASSEMBLY	1
3	960-0036	TRAIN WASH TOP BRUSH DRIVER SIDE LEG ASSEMBLY, S.S.	1
4	960-0037	TRAIN WASH TOP BRUSH PASSENGER SIDE LEG ASSEMBLY, S.S.	1
5	960-0038	TRAIN WASH TOP BRUSH COUNTERWEIGHT ARM ASSEMBLY, S.S.	2
6	960-0043	TRAIN WASH TOP BUSH AIR CYLINDER ASSEMBLY	2
7	760-1610	COMPLETE SHOCK WITH BUSHING, 13-1/2", BLACK	2
8	960-0040	TRAIN WASH TOP BRUSH WEIGHT ASSEMBLY WITH 3 BLOCKS, S.S.	1
9	960-0039	TRAIN WASH TOP BRUSH WEIGHT ASSEMBLY WITH 4 BLOCKS, S.S.	2
10	900-5223-D	TRAIN WASH TOP BRUSH SIDE FRAME, DRIVER SIDE, S.S.	1
11	900-5223-P	TRAIN WASH TOP BRUSH SIDE FRAME, PASSENGER SIDE, S.S.	1
12	900-5200	TRAIN WASH BASIC BULKHEAD, S.S.	1
13	900-5201	TRAIN WASH BASIC LEG, S.S.	2
14	870-1400	FLAT WASHER, 1/2", SAE, 18-8 STAINLESS STEEL	28
15	820-1655	HEX CAP SCREW, 1/2"-13 X 8" LG., 18-8 STAINLESS STEEL	14
16	840-2000	LOCK NUT, 1/2"-13, 18-8 STAINLESS STEEL	14

<p>N/S CORPORATION</p> <p>THE INFORMATION CONTAINED IN THIS DRAWING IS THE SOLE PROPERTY OF N/S CORPORATION. ANY REPRODUCTION IN PART OR WHOLE WITHOUT THE WRITTEN PERMISSION OF N/S CORPORATION IS PROHIBITED.</p>	<p>DIMENSION TOLERANCES (INCH): FRACTIONAL ± 1/16" TWO PLACE DECIMAL ± 0.03 THREE PLACE DECIMAL ± 0.005</p> <p>ANGULAR TOLERANCES (DEGREE): INTEGER NUMBER ± 1° ONE PLACE DECIMAL ± 0.2°</p>	SCALE	Y.S.	PART NAME		
		1:20	CHECKED BY	TRAIN WASH TOP BRUSH, S.S., STAND ALONE		
			APPROVED BY	PART NUMBER	REV.	
			INITIAL RELEASE DATE	TW-TB-S	-	
	INITIAL RELEASE ERF#	0660	SHEET 1 OF 1			